

Cook Sphere®

INFLATION DEVICE

Step 1

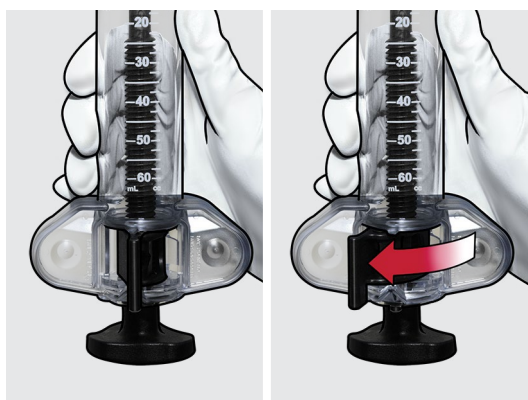

Ensure the inflation device is in the unlocked position by pushing the locking lever to the **LEFT**.

Step 2

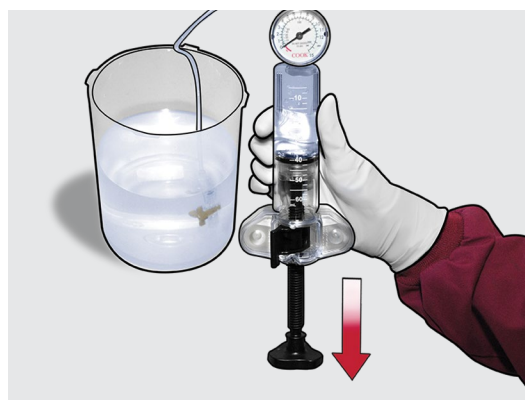

Fill the barrel with the appropriate amount of water or contrast.

- 40 cc of fluid for non-biliary dilation balloons
- 15 cc of fluid for biliary dilation balloons

Step 3

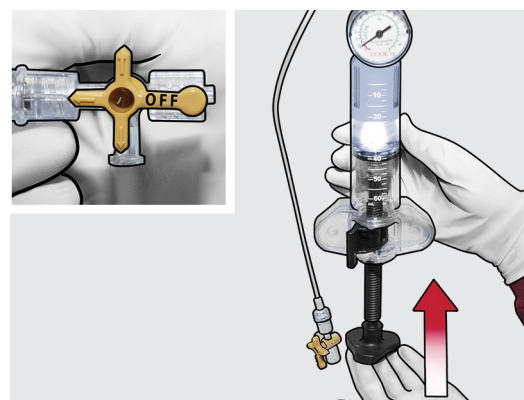

Hold the inflation device upright to allow all the air to rise to the top of the barrel. Utilizing the 3-way stopcock, turn the **OFF** knob of the stopcock towards the balloon catheter port and advance the plunger to purge any excess air from the system.

Step 4

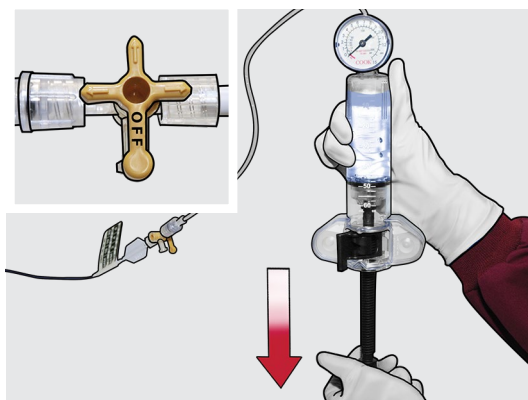

Connect the stopcock to the balloon catheter. Turn the **OFF** knob of the stopcock towards the side port.

Pull negative pressure to remove any excess air from the balloon by pulling back on the plunger as far as possible.

Step 5

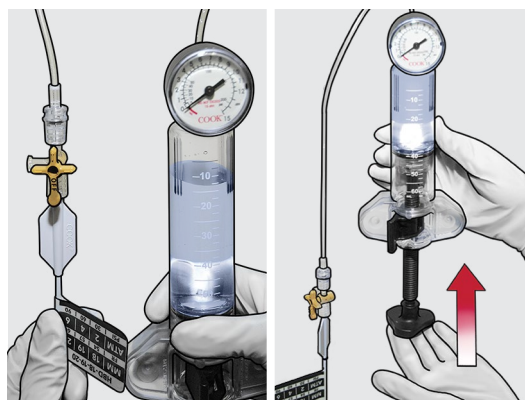

Hold the inflation device upright and turn the **OFF** knob of the stopcock towards the balloon catheter port. Advance the plunger to purge any excess air.

Step 6

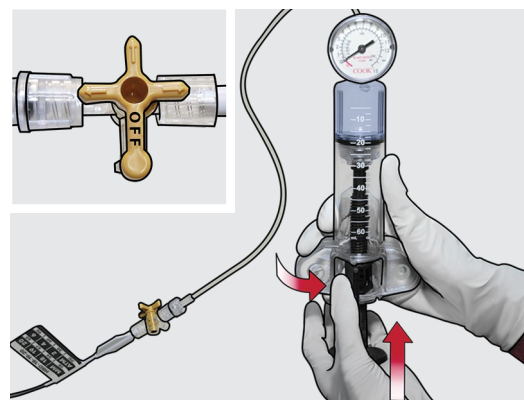

Prior to inflation, turn the **OFF** knob of the stopcock towards the side port.

To inflate, advance the plunger until you meet resistance then lock the inflation device by pushing the locking lever to the **CENTER** position.

Step 7

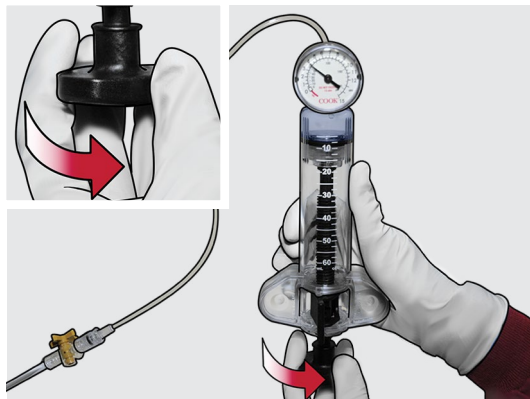

Turn the plunger clockwise until you have reached the desired pressure.

Step 8a

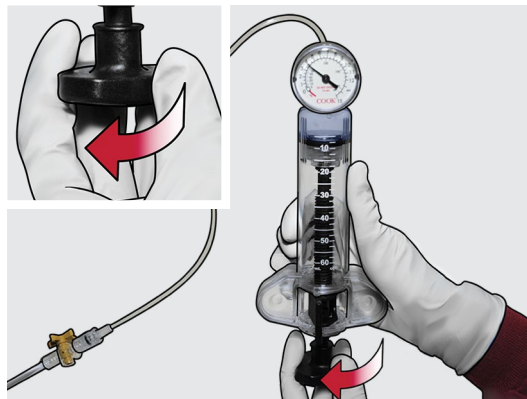

To gradually deflate, leave the locking lever in the **CENTER** position and turn the plunger counterclockwise until you have reached the desired deflation pressure.

Step 8b

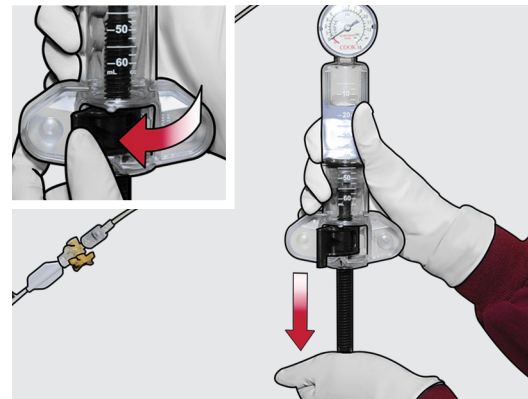

To rapidly deflate, push the locking lever to the **LEFT** and pull back on the plunger as far as possible. To allow for continued deflation, relock the inflation device by pushing the locking lever to the **CENTER** position and let go of the device.

Refer to current instructions for use for detailed information.

Customer Service

EU Website: cookmedical.eu
 EDI: cookmedical.eu/edi
 Distributors: +353 61239240, ssc.distributors@cookmedical.com
 Austria: +43 179567121, oe.orders@cookmedical.com
 Belgium: +32 27001633, be.orders@cookmedical.com
 Denmark: +45 38487607, da.orders@cookmedical.com
 Finland: +358 972519996, fi.orders@cookmedical.com
 France: +33 171230269, fr.orders@cookmedical.com
 Germany: +49 6950072804, de.orders@cookmedical.com
 Hungary: +36 17779199, hu.orders@cookmedical.com
 Ireland: +353 61239252, ie.orders@cookmedical.com
 Italy: +39 0269682853, it.orders@cookmedical.com
 Netherlands: +31 202013367, nl.orders@cookmedical.com
 Norway: +47 23162968, no.orders@cookmedical.com
 Spain: +34 912702691, es.orders@cookmedical.com
 Sweden: +46 858769468, se.orders@cookmedical.com
 Switzerland - French: +41 448009609, fr.orders@cookmedical.com
 Switzerland - Italian: +41 448009609, it.orders@cookmedical.com
 Switzerland - German: +41 448009609, de.orders@cookmedical.com
 United Kingdom: +44 2073654183, uk.orders@cookmedical.com

USA Website: cookmedical.com
 EDI: cookmedical.com/edi.do
Americas:
 Phone: +1 812.339.2235, 800.457.4500, Fax: 800.554.8335
 E-mail: orders@cookmedical.com
Australia:
 Phone: +61 734346000, 1800777222, Fax: +61 734346001, 1800077283
 E-mail: cau.custserv@cookmedical.com



AI, ESC, IR, OHNS, PI, RH, SUR-85X11