

# EchoTip Insight™

PORTOSYSTEMIC PRESSURE GRADIENT MEASUREMENT SYSTEM

## System Prep 1

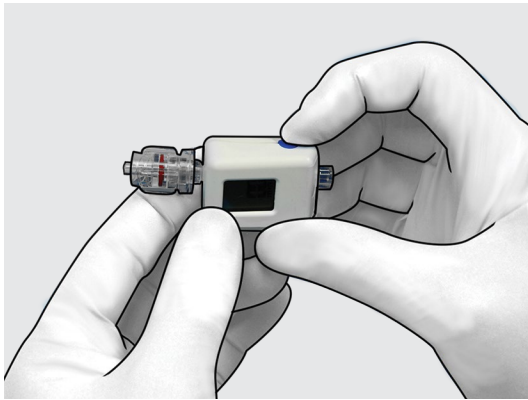

Inspect and remove all components from their individual packaging.

Remove the Luer cap from the transducer. Switch on the transducer as outlined in the Compass™ CT Instructions for Use.

## System Prep 2

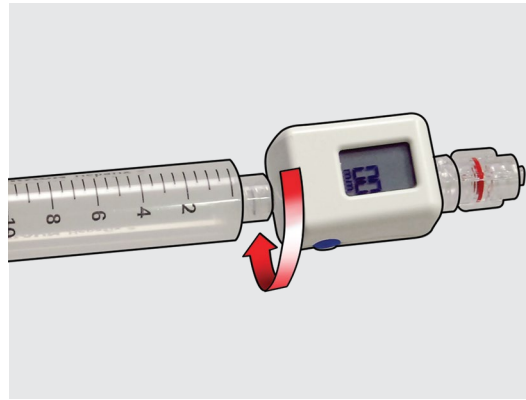

Fill the 10 mL syringe with sterile fluid, ensuring that all large air bubbles are removed from the syringe.

Attach the prepared syringe to the female Luer fitting of the transducer.

## System Prep 3

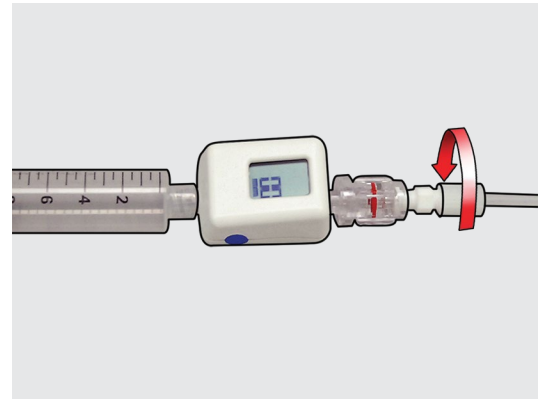

Attach the male Luer lock fitting of the transducer to the white female Luer of the connecting tube and secure tightly.

## System Prep 4

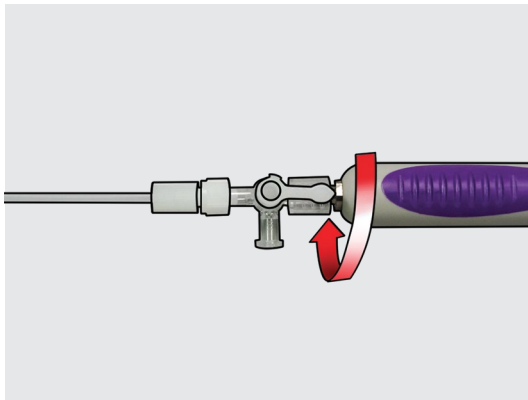

Attach the male Luer lock fitting of the connecting tube stopcock to the female Luer fitting on the needle handle and secure tightly.

**NOTE:** The system is now fully assembled.

## System Prep 5

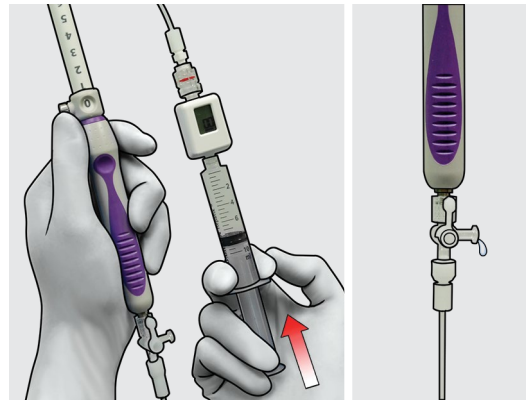

Prime the system up to the stopcock by slowly advancing plunger into syringe, ensuring no large air bubbles are present in the system.

**NOTE:** Fluid should be visible exiting the sideport of the stopcock.

## System Prep 6

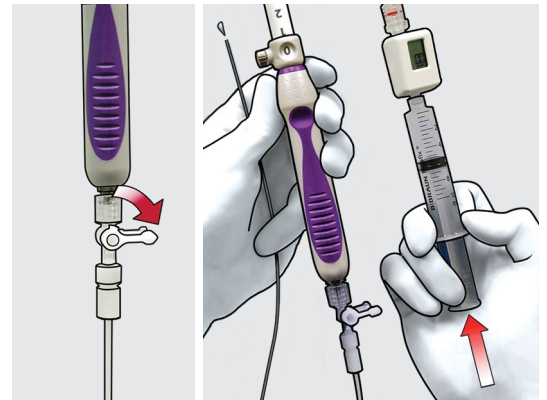

Adjust the stopcock to close the sideport before proceeding to prime the needle with minimum 1 mL of sterile fluid.

**NOTE:** Fluid should be visible exiting the distal tip of the sheath.

## Step 1

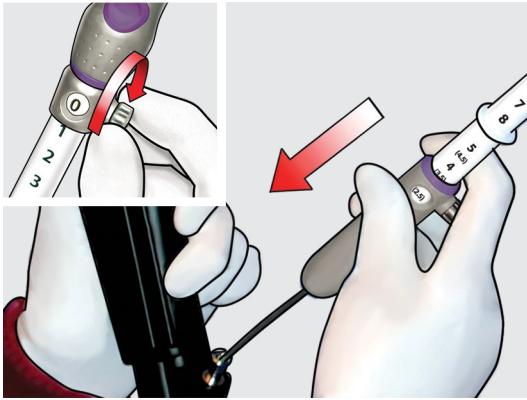

Identify the desired vasculature. Ensure the needle is retracted into the sheath before inserting the device into the endoscope. Advance the device into the endoscope until the fittings meet. Attach the device by rotating handle clockwise.

## Step 2

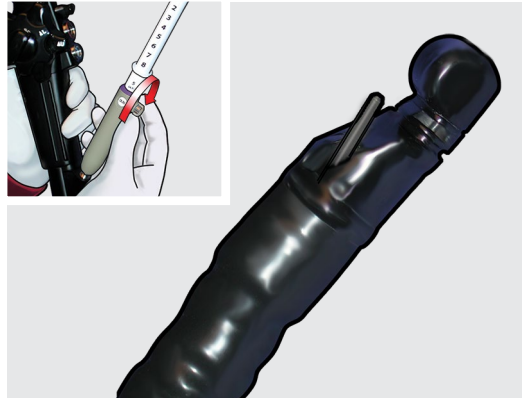

Adjust the sheath to the desired position until the sheath has emerged from the working channel of the endoscope.

## Step 3

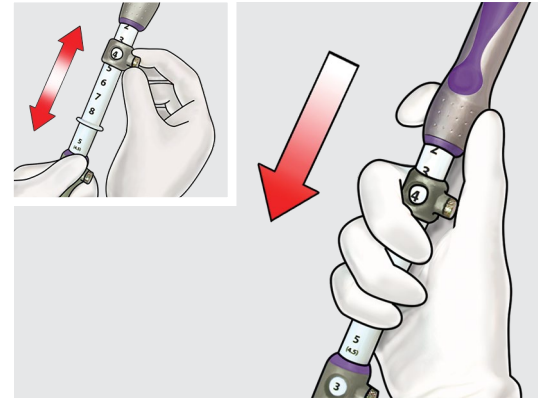

Set the needle extension to the desired length by loosening the thumbscrew on the safety ring, and advance until the desired reference mark appears in the window, then tighten the thumbscrew. Advance the needle into the desired vessel, either the hepatic or portal vein or their branches.

## Step 4

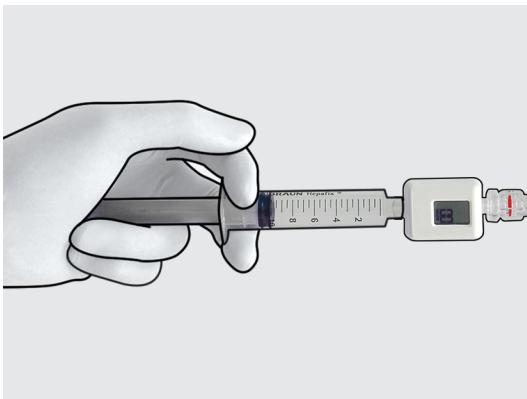

Using the prepared syringe, instill up to 0.5 mL of sterile fluid.

While maintaining the position of both the needle tip and the transducer, allow time for the pressure reading to equilibrate.

Repeat this step to obtain triplicate measurements from the same vessel.

## Step 5

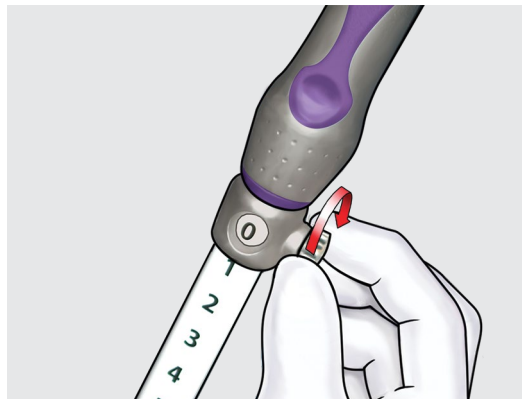

Retract the needle completely into the sheath and lock the thumbscrew on the safety ring at the 0 cm mark.

Reposition the endoscope and identify the second vessel to be accessed (opposite of the vessel accessed in Step 3).

Obtain triplicate measurements in this vessel by repeating Steps 3 and 4.

## Step 6

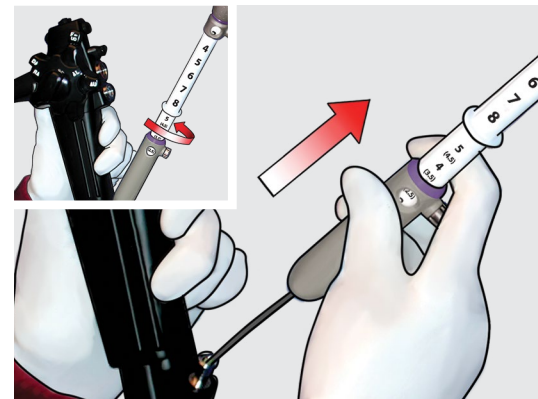

Retract the needle completely into the sheath and lock the thumbscrew on the safety ring at the 0 cm mark.

Disconnect the needle from the fitting on the scope by rotating the handle counterclockwise and withdraw the entire device from the endoscope.

Refer to the current Instructions for Use for detailed system use.

### Customer Service

EU Website: [cookmedical.eu](http://cookmedical.eu)  
EDI: [cookmedical.eu/edi](http://cookmedical.eu/edi)  
Distributors: +353 61239240, [ssc.distributors@cookmedical.com](mailto:ssc.distributors@cookmedical.com)  
Austria: +43 179567121, [oe.orders@cookmedical.com](mailto:oe.orders@cookmedical.com)  
Belgium: +32 27001702, [be.orders@cookmedical.com](mailto:be.orders@cookmedical.com)  
Denmark: +45 38487607, [da.orders@cookmedical.com](mailto:da.orders@cookmedical.com)  
Finland: +358 972519996, [fi.orders@cookmedical.com](mailto:fi.orders@cookmedical.com)  
France: +33 171230269, [fr.orders@cookmedical.com](mailto:fr.orders@cookmedical.com)  
Germany: +49 6950072804, [de.orders@cookmedical.com](mailto:de.orders@cookmedical.com)  
Hungary: +36 17779199, [hu.orders@cookmedical.com](mailto:hu.orders@cookmedical.com)  
Iceland: +354 8007615, [IS.orders@cookmedical.com](mailto:IS.orders@cookmedical.com)  
Ireland: +353 61239252, [ie.orders@cookmedical.com](mailto:ie.orders@cookmedical.com)  
Italy: +39 0269682853, [it.orders@cookmedical.com](mailto:it.orders@cookmedical.com)  
Netherlands: +31 202013367, [nl.orders@cookmedical.com](mailto:nl.orders@cookmedical.com)  
Norway: +47 23162968, [no.orders@cookmedical.com](mailto:no.orders@cookmedical.com)  
Spain: +34 912702691, [es.orders@cookmedical.com](mailto:es.orders@cookmedical.com)  
Sweden: +46 858769468, [se.orders@cookmedical.com](mailto:se.orders@cookmedical.com)  
Switzerland - French: +41 448009609, [fr.orders@cookmedical.com](mailto:fr.orders@cookmedical.com)  
Switzerland - Italian: +41 448009609, [it.orders@cookmedical.com](mailto:it.orders@cookmedical.com)  
Switzerland - German: +41 448009609, [de.orders@cookmedical.com](mailto:de.orders@cookmedical.com)  
United Kingdom: +44 2073654183, [uk.orders@cookmedical.com](mailto:uk.orders@cookmedical.com)

USA Website: [cookmedical.com](http://cookmedical.com)  
EDI: [cookmedical.com/edi.do](http://cookmedical.com/edi.do)  
Americas:  
Phone: +1 812.339.2235, 800.457.4500, Fax: 800.554.8335  
E-mail: [customersupport@cookmedical.com](mailto:customersupport@cookmedical.com)  
Australia:  
Phone: +61 734346000, 1800777222, Fax: +61 734346001, 1800077283  
E-mail: [cau.custserv@cookmedical.com](mailto:cau.custserv@cookmedical.com)



AI, ESC, IR, OHNS, PI, RH, SUR-8.5X11