

Extract salivary stones.

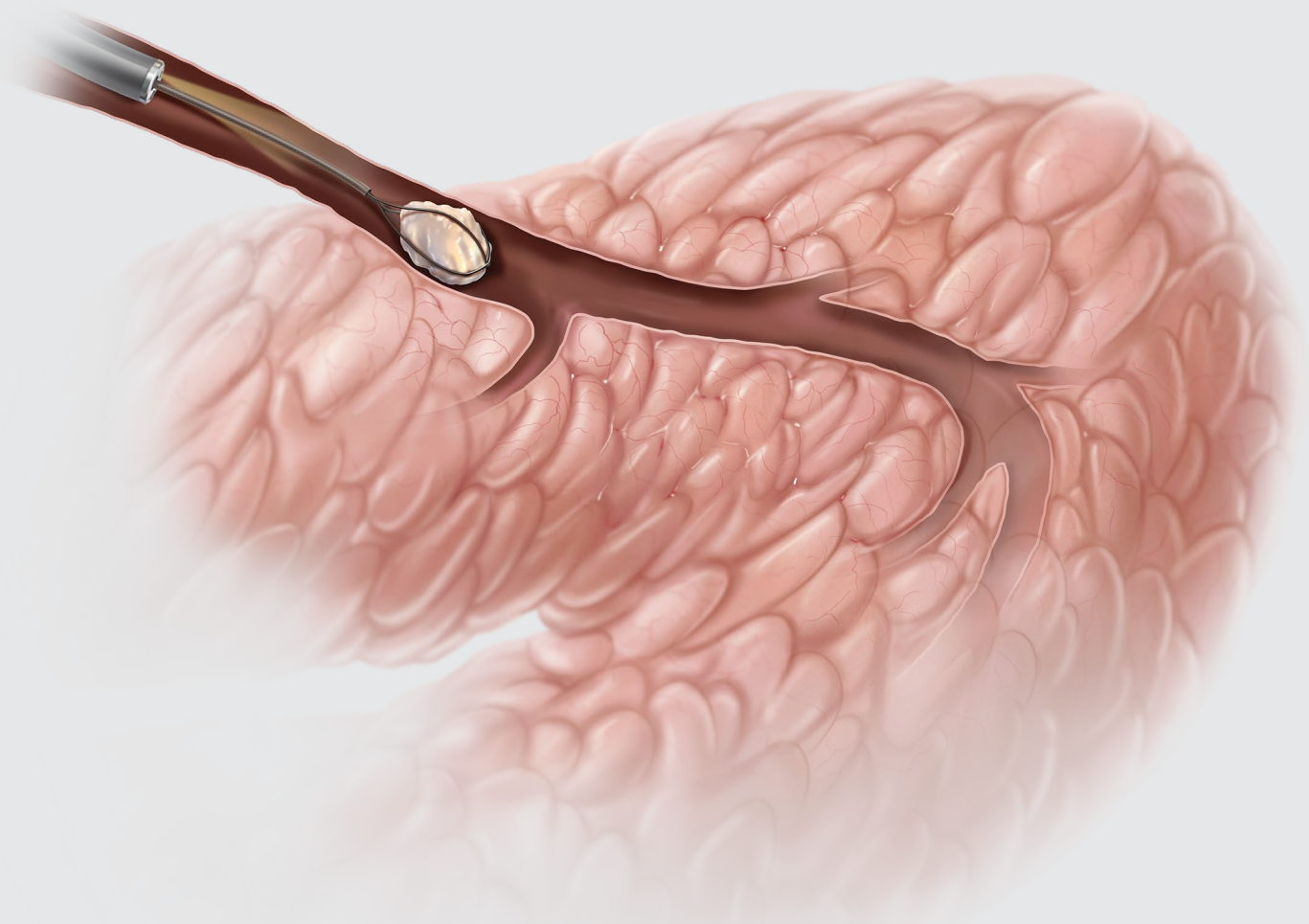

Illustration by Lisa Clark

NCircle[®]

TIPLESS SALIVARY STONE EXTRACTOR

Atraumatic design

The tipless design minimizes trauma to the duct and reduces the risk of ductal wall perforation.

Ergonomic

The handle is easy to use and allows you to deploy the stone extractor single-handedly.

Durable

The stone extractor's nitinol material is flexible and kink resistant.

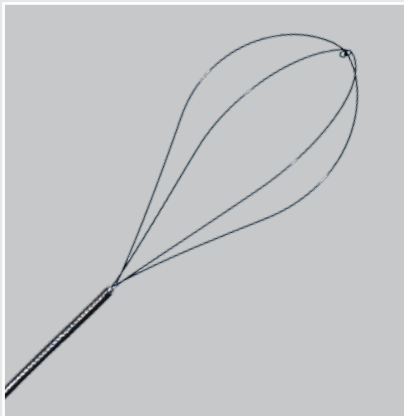

NCircle®

TIPLESS SALIVARY STONE EXTRACTOR

Used for manipulation, entrapment and extraction of calculi and other foreign bodies in the salivary ducts, and to minimize migration of salivary stones during interventional procedures.

Order Number	Reference Part Number	Catheter Fr	Catheter Length cm	Basket Diameter mm
G23797	SSEB-1.5-115-10	1.5	115	10

Related products

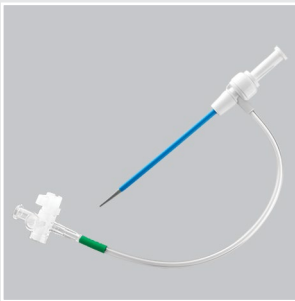

Kolenda Salivary Access Introducer Set

Used for the introduction of diagnostic or interventional devices in the submandibular salivary duct.

Order Number	Reference Part Number	Introducer ID mm/inch	Wire Guide Diameter inch	Sheath Length cm
G24129	SDAS-6.0-18	2.2/.087	.018	5.5
G24132	SDAS-5.0-18	1.9/.074	.018	5.5

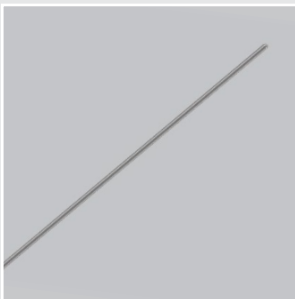

Wire guides

Used to gain and maintain access to the salivary duct.

Order Number	Reference Part Number	Wire Guide Diameter inch	Wire Guide Length cm	Tip Configuration
G02274	C-SF-15-50	.015	50	Straight
G02255	C-SF-18-40	.018	40	Straight

Some products or part numbers may not be available in all markets. Contact your local Cook Medical sales representative or Customer Service for details. Please see product risk information in the IFU at cookmedical.eu.

Customer Service

EU Website: cookmedical.eu
 EDI: cookmedical.eu/edi
 Distributors: +353 61239240, ssc.distributors@cookmedical.com
 Austria: +43 179567121, oe.orders@cookmedical.com
 Belgium: +32 27001702, be.orders@cookmedical.com
 Denmark: +45 38487607, da.orders@cookmedical.com
 Finland: +358 972519996, fi.orders@cookmedical.com
 France: +33 171230269, fr.orders@cookmedical.com
 Germany: +49 6950072804, de.orders@cookmedical.com
 Hungary: +36 17779199, hu.orders@cookmedical.com
 Iceland: +354 800 7615, is.orders@cookmedical.com
 Ireland: +353 61239252, ie.orders@cookmedical.com
 Italy: +39 0269682853, it.orders@cookmedical.com
 Netherlands: +31 202013367, nl.orders@cookmedical.com
 Norway: +47 23162968, no.orders@cookmedical.com
 Spain: +34 912702691, es.orders@cookmedical.com
 Sweden: +46 858769468, se.orders@cookmedical.com
 Switzerland - French: +41 448009609, fr.orders@cookmedical.com
 Switzerland - Italian: +41 448009609, it.orders@cookmedical.com
 Switzerland - German: +41 448009609, de.orders@cookmedical.com
 United Kingdom: +44 2073654183, uk.orders@cookmedical.com

USA Website: cookmedical.com

EDI: cookmedical.com/edi.do

Americas:

Phone: +1 812.339.2235, 800.457.4500, Fax: 800.554.8335

E-mail: customersupport@cookmedical.com

Australia:

Phone: +61 734346000, 1800777222, Fax: +61 734346001, 1800077283

E-mail: cau.custserv@cookmedical.com



AI-ESC-IR-OHNS-PI-RH-SUR-A4